

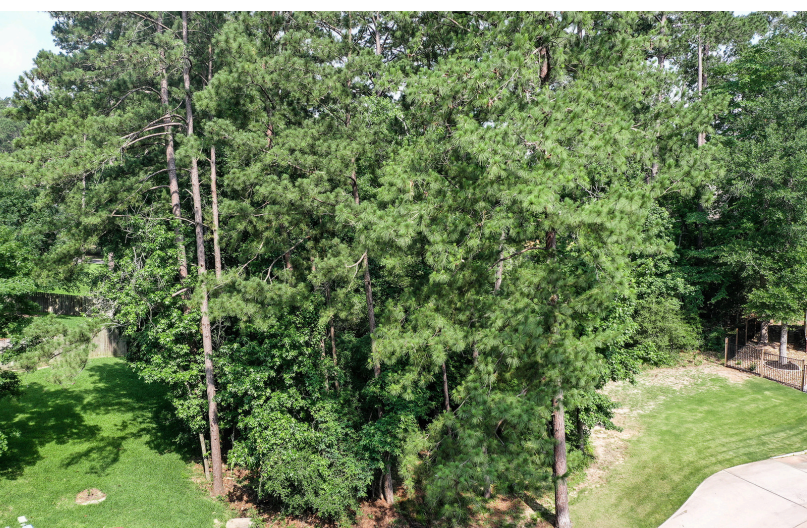

**1613 BRENTWOOD DRIVE**  
HUNTSVILLE, TEXAS | ELKINS LAKE | 0.34 +/- ACRES



# 1613 BRENTWOOD DRIVE



Located at the end of a cul-de-sac amongst some of Elkins Lake's most manicured property lies this vacant, wooded lot ready for your imagination. Just over a quarter of an acre, this property is situated in a low traffic area on the east side of the main Elkins Lake. A vibrant community, this neighborhood features a multitude of activities including 3 nine hole golf courses, two pools, tennis courts, playground, dog park, and clubhouse with cafe and pro shop. Elkins Lake is one of the most coveted communities in Walker County, and this lot is your new invitation to join.



Markham Realty  
Selling Quality Texas Properties Since 1970  
contact@markhamrealty.com  
936-295-5989 | markhamrealty.com



Scan here for additional information & photos.



Information furnished is from sources deemed reliable, but is not guaranteed by Markham Realty, Inc. The offerings are subject to change in price, errors, omissions, prior sales, or withdrawal without notice. Square footage, acreage size and lot dimensions are approximate. All persons and firms named in this brochure are licensed brokers or salespersons. Markham Realty, Inc. will co-broker with any licensed Broker if Broker and/or agent accompanies his or her prospective buyer from the first (1st) showing forward.

# 1613 BRENTWOOD DRIVE

HUNTSVILLE, TEXAS

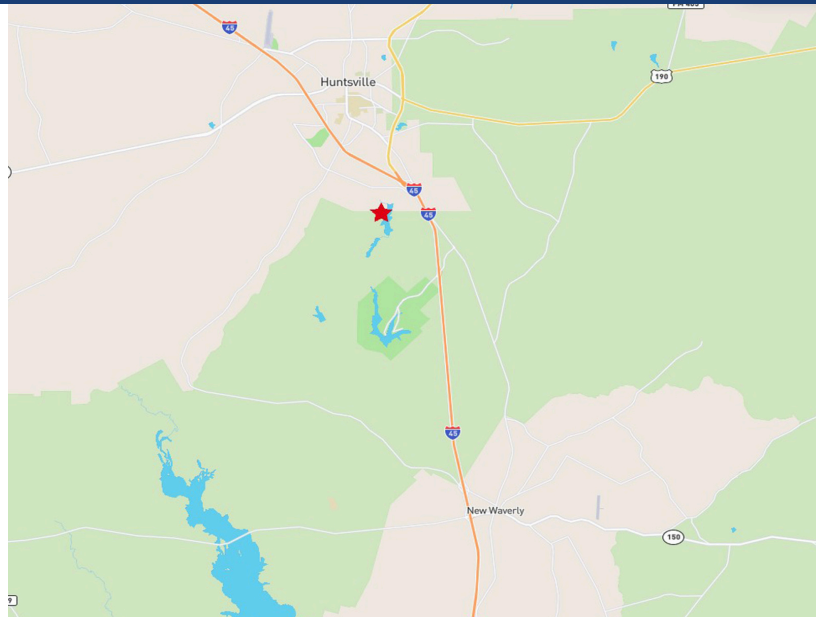
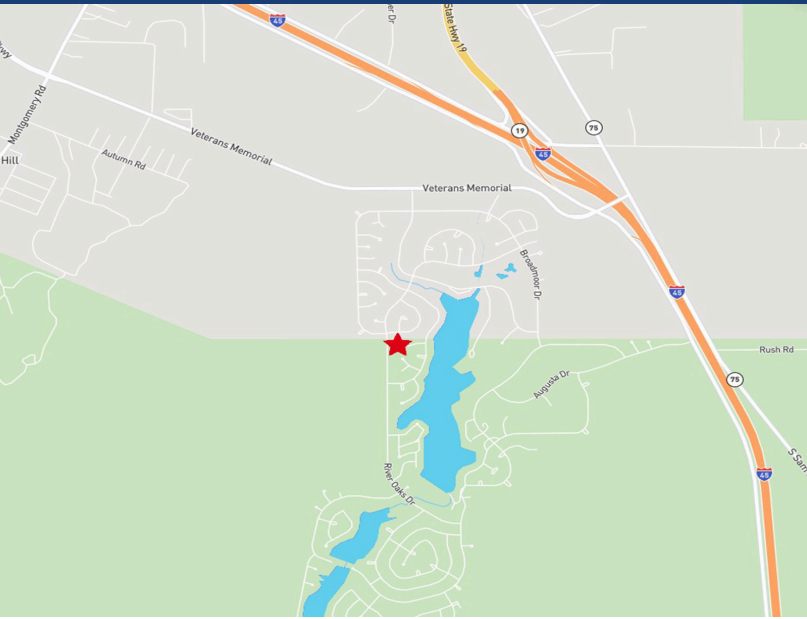

From I45, take the Veteran's Memorial exit. Go east on VM, and turn left onto Brookhollow. Go straight through the first stop sign. At the second stop sign, turn right onto River Oaks. Take first left onto Overbrook. Take first right onto Brentwood. Property is at end of street.



Markham Realty  
Selling Quality Texas Properties Since 1970  
contact@markhamrealty.com  
936-295-5989 | markhamrealty.com



Scan here for additional information & photos.



Information furnished is from sources deemed reliable, but is not guaranteed by Markham Realty, Inc. The offerings are subject to change in price, errors, omissions, prior sales, or withdrawal without notice. Square footage, acreage size and lot dimensions are approximate. All persons and firms named in this brochure are licensed brokers or salespersons. Markham Realty, Inc. will co-broker with any licensed Broker if Broker and/or agent accompanies his or her prospective buyer from the first (1st) showing forward.